

Description

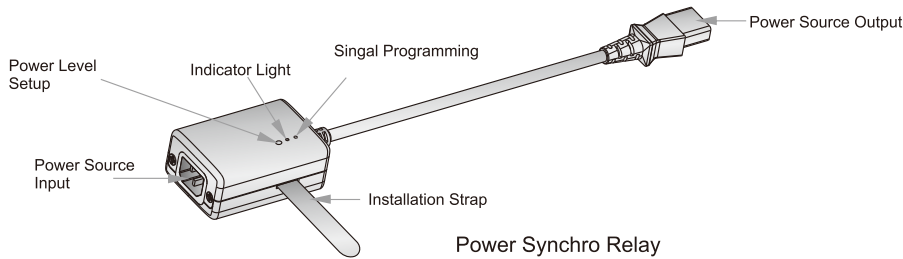

Input Voltage: 220V
 Voltage Frequency : 50/60Hz
 Max Input/output power : 5A
 Power Input: UI817
 Power Output: IEC320
 Self-Power: 1W
 Transmitting Power: 2.5mW
 Modulation Method: FM
 Transmitting Frequency : 868MHz

Directions

1

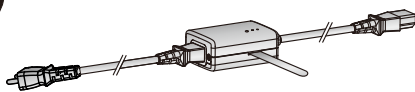

Figure 1

1. Connect power cord of projector to the power source input on the Power Synchro Relay (Figure 1).

2

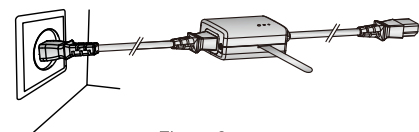

Figure 2

2. Connect the other end of the projector's power cord to the electrical socket (Figure 2). The indicator light will turn on and stay on.

3

Wireless Synchro Receiver (RF to IR)

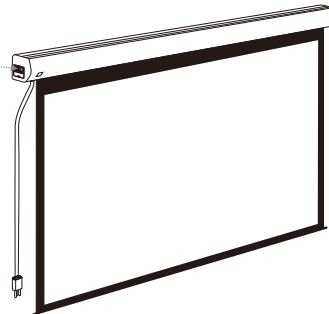
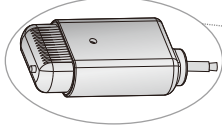
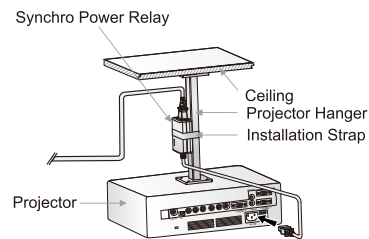

Figure 3



This product can only be used in Grandview Integrated Motorized Screen with "EXT CTRL" input .

4

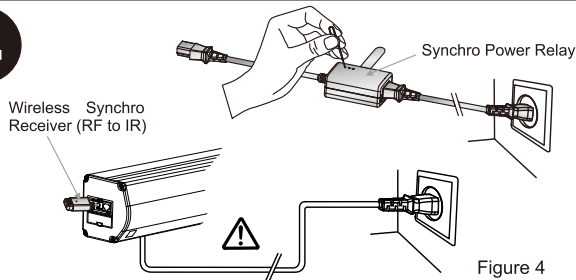

Figure 4

4. Ensure the wireless receiver is connected to the screen, press the receiver programming button by inserting a small plastic stick and the light will flash repeatedly (Figure 3). Then press the signal programming button (Figure 4), it means that the programming instructions will be synced to both devices, the receiver light will stop flashing and stay on once completed.

5

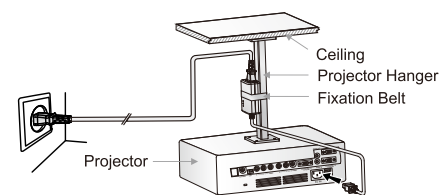

Figure 5

5. Use the installation strap to fix the Power Synchro Relay to the projector hanger (if applicable). Connect the included power source output cord into the projector.

6

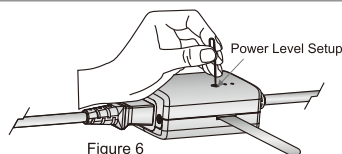

Figure 6

6. Turn on the projector, and then please press the power level setup with a small plastic stick when the LED light of projector turns on. At the time, the indicator light of Synchro Power Relay will turn on with blue-ray.

7

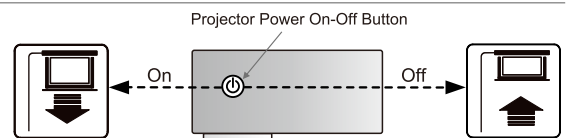

Figure 7

7. The projection screen will automatically lower when the projector is on. It will automatically retract when the projector is turned off (Figure 7).

Grandview Crystal Screen Canada Ltd.

#11- 3751 North Fraser Way,
 Marine Way Business Centre,
 Burnaby, BC, Canada V5J 5G4
 Tel: 1-604-412-9777 Fax: 1-604-412-9796
 Website: www.grandviewscreen.ca

Guangzhou Grandview Crystal Screen Co., Ltd.

No.43,Guomao Road South, Hualong Town,
 Panyu District, Guangzhou City, China
 Tel: +8620-8489-9499 Fax: +8620-8480-3343
 Website: www.grandviewscreen.com
 www.grandviewscreen.com.cn